

Apraised 4-25 1955 Apraised by Sawyer

TRACTS 2 BLOCK 6 ADDITION Fruit View

HOUSE No. 7 STREET N Fincha CITY Leaf

OWNER Emillio Silva

Section	Twp.	Range



Width x Length	Area	Height	Cubic Feet
24 x 29	696		
2 x 15	30		
x			
x			
x			
x			

check for Bath etc for 1963

Wall Ratio Total Sq. Ft. 726
Special Building Notes

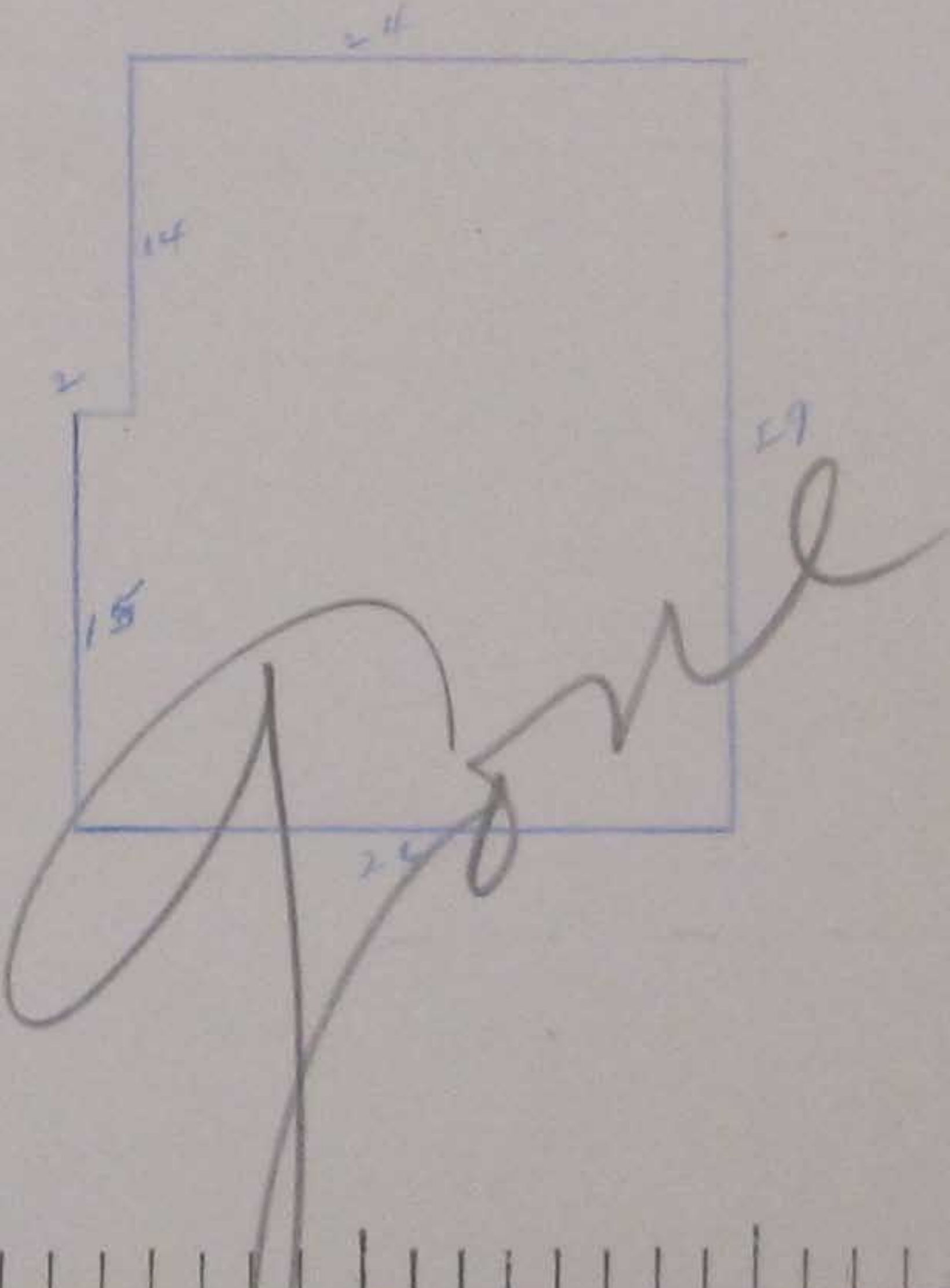
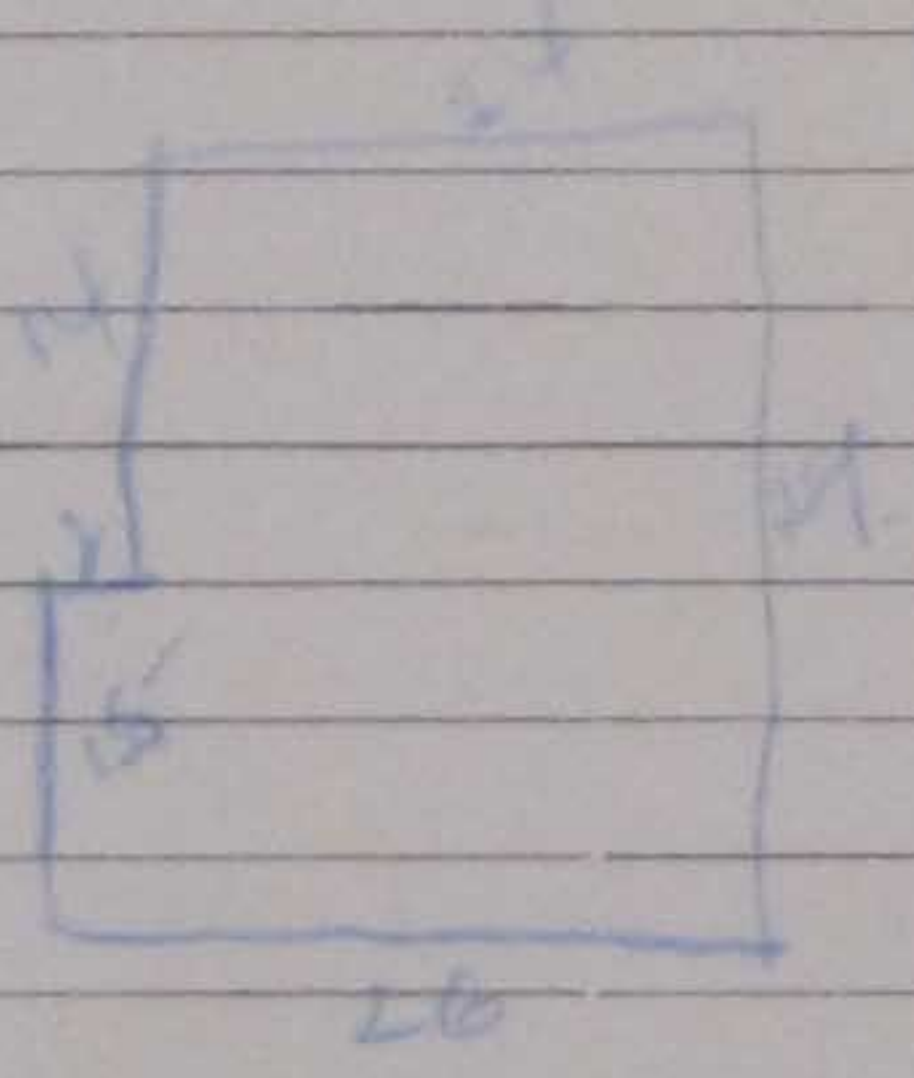

ROOMS	DESCRIPTION				
	Basem't	Give Numbers STORIES			
	1	2	3	Atic	
Living Room					
Dining Room					
Dinette					
Kitchen					
Breakfast Nook					
Bed Room					
Bath Room					
Toilet Room					
Shower Room					
Sleeping Porch					
Sun Room					
Den					
Storage Room					
Office					
Halls					

Checked By _____ Date _____

SUMMARY			ANNUAL ASSESSMENT		
Description	Amount	Year	Land	Improvements	Total
Building Permit	\$	1949	\$	\$	\$
Original Cost, Improvements Only	\$	1950	\$	\$	\$
Additions and Betterments	\$	1951	\$	\$	\$
Owner's Estimate of Present Value	\$	1952	\$	\$	\$
Private Apraisal	\$	1953	\$	\$	\$
Insurance	\$	1954	\$	\$	\$
Mortgage	\$	1955	\$	\$	\$
Monthly Rental	\$	1956	\$ 140	\$ 1650	\$ 1790
Advertised for Sale	\$	1957	\$	\$	\$
Transferred in 19	\$	1958	\$	\$	\$

Summary of Land and Building Values		Full Appraised Value
LAND	\$	
Buildings and Improvements (This Card)	\$	
Card No.		
Card No.		
Total Buildings and Improvements	\$	
Total Assessed Land	\$	
Buildings and Improvements	\$	

